

Purdue University

Purdue e-Pubs

Historical Documents of the Purdue
Cooperative Extension Service

Department of Agricultural Communication

1-1-1900

Storage of Cleaning Equipment

Ruth Hutcheson

Follow this and additional works at: <https://docs.lib.purdue.edu/agext>

Hutcheson, Ruth, "Storage of Cleaning Equipment" (1900). *Historical Documents of the Purdue Cooperative Extension Service*. Paper 903.
<https://docs.lib.purdue.edu/agext/903>

For current publications, please contact the Education Store: <https://mdc.itap.purdue.edu/>

This document is provided for historical reference purposes only and should not be considered to be a practical reference or to contain information reflective of current understanding. For additional information, please contact the Department of Agricultural Communication at Purdue University, College of Agriculture: <http://www.ag.purdue.edu/agcomm>

This document has been made available through Purdue e-Pubs, a service of the Purdue University Libraries. Please contact epubs@purdue.edu for additional information.

Replaced by HE 523

STORAGE OF CLEANING EQUIPMENT

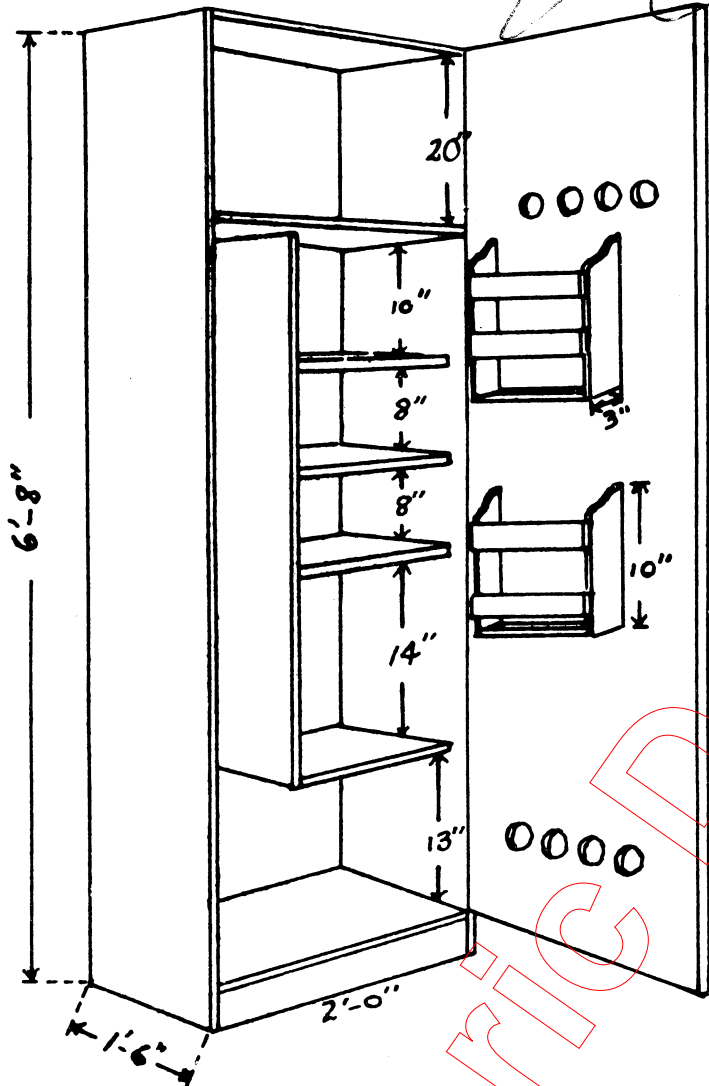

Good cleaning equipment deserves good care. The first essential of good care is providing suitable storage space. Cleaning equipment should be located where it is readily accessible from all rooms where it will be used. Storage such as a permanent closet (left) or a portable unit (below) is very suitable. If the floor of a permanent closet is raised several inches, lint will not come in under the door. The left-hand side of the closet should be fitted with hooks for equipment that will hang. The space under the lowest shelf should accommodate a small pail. Shelves of various heights care for cleaning supplies of different sizes. Bottles and other

small articles may be stored in the pockets on the door. One of the shelves may be used to accommodate a light-weight carry-all or basket for small equipment and supplies that are needed for cleaning tasks in various parts of the house.

Ventilation may be provided by leaving a space between the base of the closet and the bottom of the door and by putting holes near the top of the door. A portable closet may be constructed from plywood at a moderate cost.

