

# S.R. 66 Storm Sewer Project

---

Tunnel Design and Construction  
by  
Peggy Ganse, P.E., P.G.  
Lyman Henn, Inc.

## Overview of Presentation

---

- Tunnel design concepts
- SR-66 design issues
- Tunnel components and construction

## Tunnel Design Concepts

---

- Matching equipment, methods, and materials to ground conditions
  - Tunneling Machine
  - Initial Support
  - Final Lining
- Satisfy project goals
- Avoid disasters
- Economical

---

*Lyman Henn, Inc.*

## Design and Construction Considerations

---

- Utilities
- Third party impacts
  - Settlement
  - Traffic
  - Businesses
- Muck disposal
- Settlement
- Staging area(s)

---

*Lyman Henn, Inc.*

## Ground Settlement

---

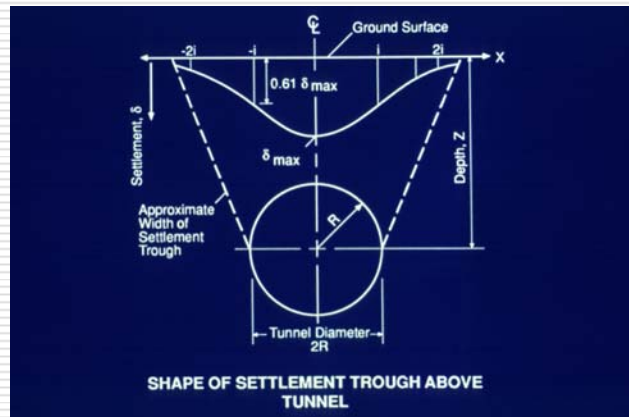

*Lyman Henn, Inc.*

## Ground Conditions & Behavior

---

- Sand below water Table: Flowing ground
- Clean sand above water: Running ground
- Dirty sand: Raveling ground
- Hard clay: Firm ground
- Soft clay: Squeezing ground
- Combinations are common

*Lyman Henn, Inc.*

## Construction Overview

---

- Shafts
- Tunnel Excavation and Support
- Pipe Installation
- Backfill Annulus and Contact Grout
- Clean Up

---

*Lyman Henn, Inc.*

## Shafts

---

- Access shaft - main work area
- Generally 0.5-2 acres required for staging
- Access shaft size depends on pipe diameter and length
- Must balance access shaft size between contractor needs/wants and costs
- Exit shafts are smaller than access shafts

---

*Lyman Henn, Inc.*

## Tunnel Excavation and Support

---

- ❑ Tailor excavation and support methods to the ground
- ❑ Must control loss of ground
- ❑ One-pass or Two-pass method
- ❑ Positive face control or open face
- ❑ Different methods better for different ground conditions

---

*Lyman Henn, Inc.*

## Two-Pass Tunnel

---

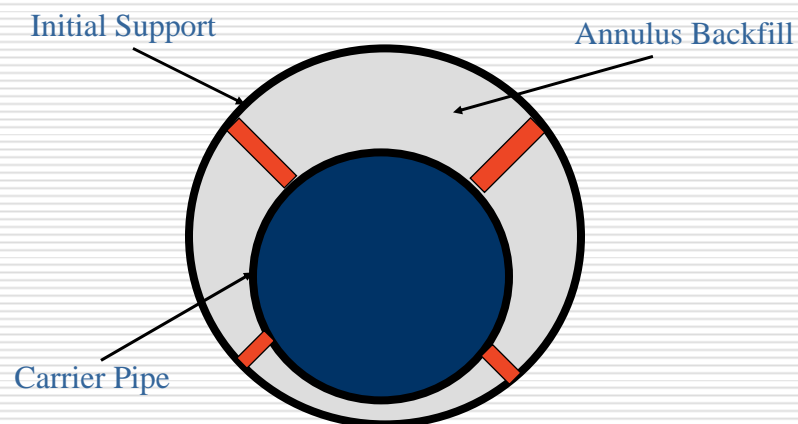

---

*Lyman Henn, Inc.*

## Circular Shield with Doors

---



*Lyman Henn, Inc.*

## Soft Ground Rotating Tunnel Head

---



*Lyman Henn, Inc.*

## Earth Pressure Balance Machine

---



*Lyman Henn, Inc.*

## Potential Problems

---

- Broken Utilities
- Surface settlement/sinkhole
- Settlement of nearby foundations
- Poor pipe connections (leaks)
- Noise complaints
- Traffic congestion

*Lyman Henn, Inc.*

## SR-66 Design Issues

---

- No open cut
- No shafts along SR-66 in this phase – no manholes, pipe jacking not allowed
- Earth Pressure Balance Machine (EPB) to control soils beneath the water table
- Control settlement of roadway, utilities, and pedestrian bridge

---

*Lyman Henn, Inc.*

## SR-66 Contract Documents

---

- Data Report
- Geotechnical Baseline Report
- Specifications – combination of prescriptive and performance requirements
- Drawings
- Overall approach – allowed as many methods as possible

---

*Lyman Henn, Inc.*



## Specifications

---

- ❑ Dewatering and water control
  - ❑ Shaft excavation and support
  - ❑ Tunnel boring machines
  - ❑ Tunnel excavation and initial support
  - ❑ Contact grouting
  - ❑ Tunnel final lining
  - ❑ Geotechnical instrumentation
  - ❑ Reinforced concrete pipe
  - ❑ Low density cellular concrete
- 

*Lyman Henn, Inc.*

## Tunnel Cross Section

---

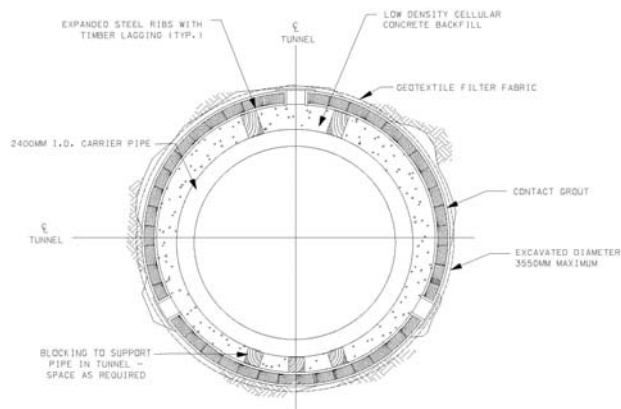

*Lyman Henn, Inc.*

# Block Outs

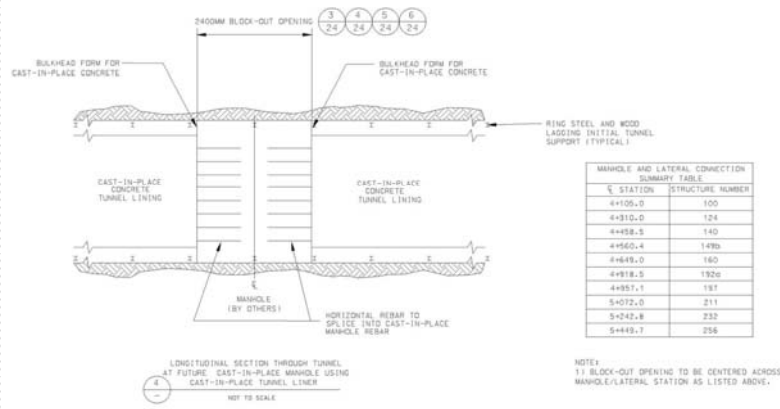

Lyman Henn, Inc.

# Pipe Block Outs

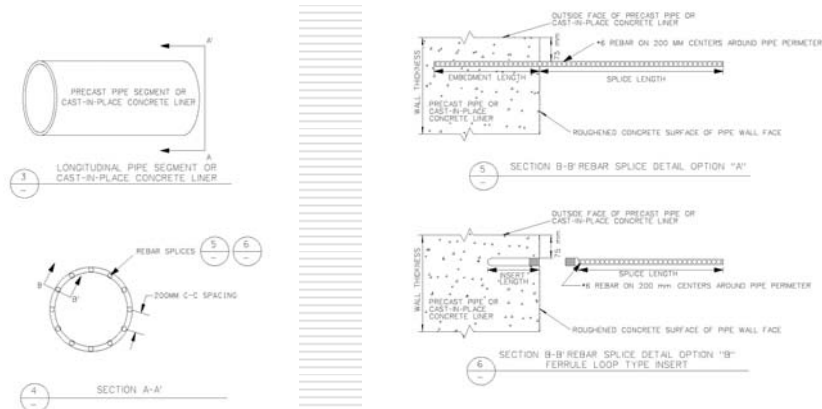

Lyman Henn, Inc.

## Existing Pump Station

---



*Lyman Henn, Inc.*

## Staging Area

---



*Lyman Henn, Inc.*

## Staging Area

---



*Lyman Henn, Inc.*

## Tunnel Supports

---



*Lyman Henn, Inc.*

## Access Shaft

---



*Lyman Henn, Inc.*

## Access Shaft Layout

---



*Lyman Henn, Inc.*

## Access Shaft

---



*Lyman Henn, Inc.*

## Tunnel Heading

---



*Lyman Henn, Inc.*



## Set of Tunnel Supports

---



*Lyman Henn, Inc.*

## Tail Tunnel

---



*Lyman Henn, Inc.*

## Block-Out in Tunnel

---



*Lyman Henn, Inc.*

## Special Pipe at Block-Out

---



*Lyman Henn, Inc.*



## Pipe at Plant

---



*Lyman Henn, Inc.*

## Precast Pipe

---



*Lyman Henn, Inc.*

## Lowering Pipe into Shaft

---



*Lyman Henn, Inc.*

## Pipe Placement Using Carrier

---



*Lyman Henn, Inc.*

# Questions?

---

---

*Lyman Henn, Inc.*